



SK (DIN 69871)



2019 Catalog

World-class products

Precise quality

Satisfied customer

ZERTIFIKAT ♦ CERTIFICATE ♦ 認証証書 ♦ CERTIFICADO ♦ CERTIFICAT



CERTIFICATE

The Certification Body
of TÜV SÜD South Asia Private Limited
certifies that



Falcon Toolings
SF No -205/1 & 2, Kuttai Thottam, Kalapatti post
Coimbatore- 641048, Tamil Nadu, INDIA

has implemented a Quality Management System
in accordance with ISO 9001:2015
For Scope of

Design, Development, Manufacturing & Supply of Toolings

The certificate is valid in conjunction
with the main-certificate from 2018-01-20 until 2021-01-19
Subject to successful completion of annual periodic audits
The present status of this Certificate can be obtained on www.tuv.sud.in
Further clarifications regarding the scope of this certificate may be obtained by consulting the certification body

Certificate Registration No. **99 100 10587/01**

Date of Initial certification : 2015-01-20

Certification Body
of TÜV SÜD South Asia Private Limited, Mumbai
Member of TÜV SÜD Group



SK (DIN 69871)

Table of contents

Description	Page	Description	Page
SHK DETAIL - Shank Detail			
Machine Design	4	Cutter Clamping Screw	17
Form A , AD & AD/B	4	Accessories	17
ANSI / CAT - Form AD	4		
ERS - ER Collet Chuck		MTA - Morse Taper Adaptor	
SK – Form ADB – G6.3	5	SK – Form AD	18
SK 40 – Standard GPL	5	SK 40 – Standard GPL	18
SK 40 – GPL = 100 mm	5	SK 50 – Standard GPL	18
SK 40 - GPL = 160 mm	5	SK – Form A	18
SK 50 – Standard GPL	6	SK 40 – Extended Length	18
SK 50 - GPL = 100 mm	6	SK 50 - Extended Length	19
SK 50 - GPL = 160 mm	6	Accessories	19
Spares	7		
Stopper Screw.....	7	SFC - Shrink Fit Holder	
Accessories	7	SK – Form ADB – G6.3	20
		SK 40 – Standard GPL	20
SCCH - Short Collet Chuck		Spares	20
SK40 Form AD	8	Accessories	20
SK50 Form AD	8		
Spares	8	DCH - Drill Chuck Adaptor	
Accessories	8	SK – Form A	21
		SK 40 – Standard GPL	21
EMH - End Mill Holder (DIN 1835 - B)		SK 50 – Standard GPL	21
SK – Form ADB – G6.3	9	Accessories	21
SK 40 – Standard GPL	9		
SK 40 - GPL = 160 mm	9	BLA - Boring Blank Adaptor	
SK 50 – Standard GPL	10	SK – Form A	22
SK 50 - GPL = 160mm	10	SK 40 – Standard GPL	22
Spares	11	SK 50 – Standard GPL	22
Grub Screw	11	Accessories	22
Accessories	11		
SLA - Side Lock Holder			
SK 40 - Form AD	12		
SK 50 - Form AD	12		
Spares	13		
Grub Screw	13		
Accessories	13		
SMS - Face Mill Arbor			
SK – Form ADB – G6.3	14		
SK 40 – Standard GPL	14		
SK 50 – Standard GPL	14		
Spares	15		
Cutter Clamping Screw	15		
Driving Key.....	15		
Accessories	15		
CMH - Combi Shell Mill Holder			
SK – Form AD – G6.3	16		
SK 40 – Standard GPL	16		
SK 50 – Standard GPL	16		
Spares	16		
Drive Ring	16		
Parallel Key	17		

SK (DIN 69871)

Machine Design

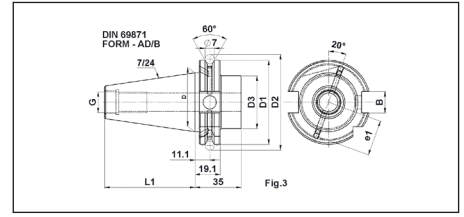
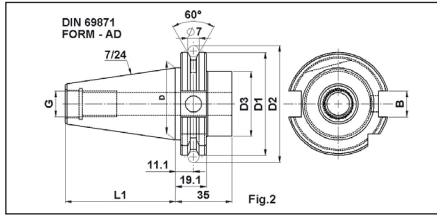
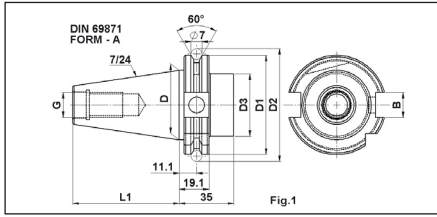

Form A , AD & AD/B

Machine Design	TAPER ISO	D	D1	D2	D3	L	G	B	e1
SK40	40	44.45	63.55	72.3	50.0	68.4	M16	16.1	27
SK45	45	57.15	82.55	91.35	63.0	82.7	M20	19.3	35
SK50	50	69.85	97.50	107.25	80.0	101.75	M24	25.7	42

ANSI / CAT - Form AD

Machine Design	TAPER ISO	D	D1	D2	D3	L	B	G
CAT40 - AD	40	44.45	63.5	72.35	44.45	68.23	16.38	5/8-11
CAT45 - AD	45	57.15	82.55	91.35	57.15	82.55	19.55	3/4-10
CAT50 - AD	50	69.85	98.43	107.64	69.85	101.6	25.91	1" -8

Pre balanced G6.3@15000 RPM
 Fine balancing G2.5@25000 RPM on request



SK (DIN 69871)

SK – Form ADB – G6.3

SK 40 – Standard GPL

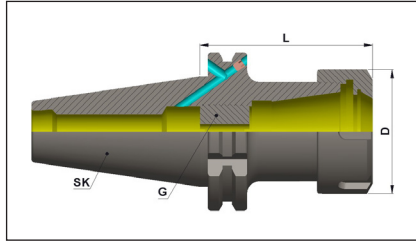
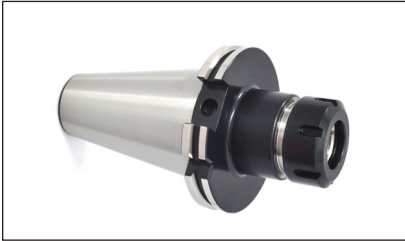

Part No.	Product name	Taper	Form	Size	L	Clamping range	G	D	Nut	Kgs	Group
F1S409A-ERS16063	SK40 ADB ER 16 063	40	AD/B	ER16	63	1-10	SCW7/16	28	F15500-16ERH	0.9	B
F1S409A-ERS25060	SK40 ADB ER 25 060	40	AD/B	ER25	60	1-16	M18X1.5	42	F15500-25ERS	1	B
F1S409A-ERS32070	SK40 ADB ER 32 070	40	AD/B	ER32	70	2-20	M22X1.5	50	F15500-32ERS	1.1	B
F1S409A-ERS40080	SK40 ADB ER 40 080	40	AD/B	ER40	80	3-26	M22X1.5	63	F15500-40ERS	1.4	B

SK 40 – GPL = 100 mm

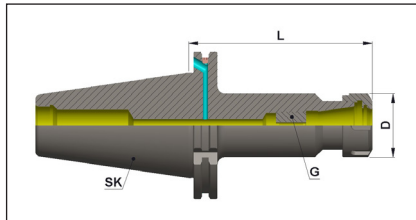

Part No.	Product name	Taper	Form	Size	L	Clamping range	G	D	Nut	Kgs	Group
F1S409A-ERS16100	SK40 ADB ER 16 100	40	AD/B	ER16	100	1-10	SCW7/16	28	F15500-16ERH	1.1	B
F1S409A-ERS25100	SK40 ADB ER 25 100	40	AD/B	ER25	100	1-16	M18X1.5	42	F15500-25ERS	1.3	B
F1S409A-ERS32100	SK40 ADB ER 32 100	40	AD/B	ER32	100	2-20	M22X1.5	50	F15500-32ERS	1.3	B
F1S409A-ERS40100	SK40 ADB ER 40 100	40	AD/B	ER40	100	3-26	M28X1.5	63	F15500-40ERS	1.6	B

SK 40 - GPL = 160 mm

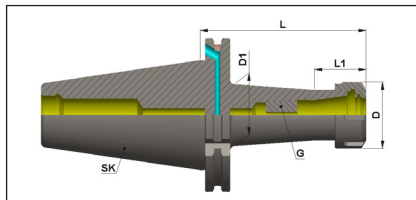

Part No.	Product name	Taper	Form	Size	L	Clamping range	G	D	Nut	Kgs	Group	D1	L1
F1S409A-ERS16160	SK40 ADB ER 16 160	40	AD/B	ER16	160	1-10	SCW7/16	28	F15500-16ERH	1.5	B	22	34
F1S409A-ERS25160	SK40 ADB ER 25 160	40	AD/B	ER25	160	1-16	M18X1.5	42	F15500-25ERS	1.9	B	32	33
F1S409A-ERS32160	SK40 ADB ER 32 160	40	AD/B	ER32	160	2-20	M22X1.5	50	F15500-32ERS	1.9	B	40	33

Pre balanced G6.3@15000 RPM
 Fine balancing G2.5@25000 RPM on request



SK (DIN 69871)

SK 50 – Standard GPL

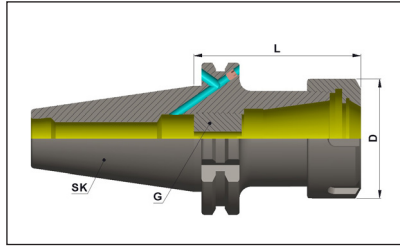
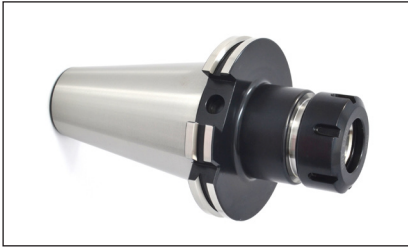

Part No.	Product name	Taper	Form	Size	L	Clamping range	G	D	Nut	Kgs	Group
F1S509A-ERS25070	SK50 ADB ER 25 070	50	AD/B	ER25	70	1-16	M18X1.5	42	F15500-25ERS	2.8	B
F1S509A-ERS32070	SK50 ADB ER 32 070	50	AD/B	ER32	70	2-20	M22X1.5	50	F15500-32ERS	3	B
F1S509A-ERS40080	SK50 ADB ER 40 080	50	AD/B	ER40	80	3-26	M28X1.5	63	F15500-40ERS	3.1	B

SK 50 - GPL = 100 mm

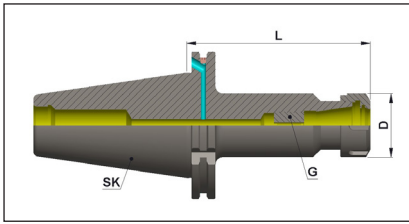

Part No.	Product name	Taper	Form	Size	L	Clamping range	G	D	Nut	Kgs	Group
F1S509A-ERS16100	SK50 ADB ER 16 100	50	AD/B	ER16	100	1-10	SCW7/16	28	F15500-16ERH	2.9	B
F1S509A-ERS25100	SK50 ADB ER 25 100	50	AD/B	ER25	100	1-16	M18X1.5	42	F15500-25ERS	3.2	B
F1S509A-ERS32100	SK50 ADB ER 32 100	50	AD/B	ER32	100	2-20	M22X1.5	50	F15500-32ERS	3.4	B
F1S509A-ERS40100	SK50 ADB ER 40 100	50	AD/B	ER40	100	3-26	M28X1.5	63	F15500-40ERS	3.5	B

SK 50 - GPL = 160 mm

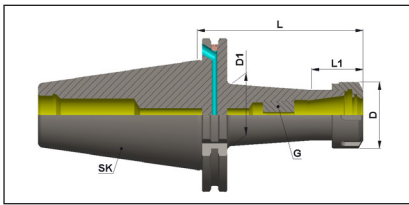

Part No.	Product name	Taper	Form	Size	L	L1	Clamping range	G	D	D1	Nut	Kgs	Group
F1S509A-ERS16160	SK50 ADB ER 16 160	50	AD/B	ER16	160	30.6	1-10	SCW7/16	28	28	F15500-16ERH	3.1	B
F1S509A-ERS25160	SK50 ADB ER 25 160	50	AD/B	ER25	160	32	1-16	M18X1.5	42	40	F15500-25ERS	3.4	B
F1S509A-ERS32160	SK50 ADB ER 32 160	50	AD/B	ER32	160	33	2-20	M22X1.5	50	48	F15500-32ERS	3.8	B

Pre balanced G6.3@15000 RPM
 Fine balancing G2.5@25000 RPM on request



SK (DIN 69871)

Spares

Stopper Screw

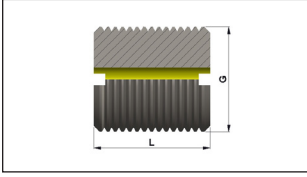

Part No.	G	L
F1SCWA-20U11	7/16	20
F1SCWM-20M06	M6	20
F1SCWM-20M14	M14	20
F1SCWM-20M18	M18	20
F1SCWM-20M22	M22	20
F1SCWM-20M28	M28	20

Accessories



For Further Details Please Refer Accessories Catalog.

Pre balanced G6.3@15000 RPM
Fine balancing G2.5@25000 RPM on request



SK (DIN 69871)

SK40 Form AD

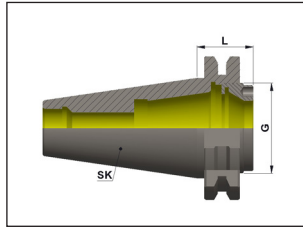

Part No.	Product name	Taper	Form	Size	Clamping range	L	Nut	D	Kgs	Group
F1S401A-ERS32025	SK40 AD ER 32 025	40	AD	ER32	2-20	25	F15500-32SER	M40x1.5	0.6	B

SK50 Form AD

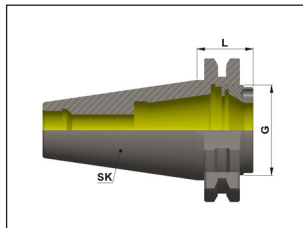

Part No.	Product name	Taper	Form	Size	L	Clamping range	Nut	D	Kgs	Group
F1S501A-ERS40026	SK50 AD ER 40 026	50	AD	ER40	26	3-26	F15500-40SER	M50X1.5	2.2	B

Spares

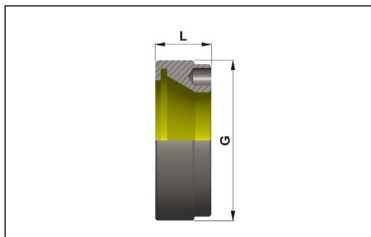

Part No.	Product name	G	L
F15500-32SER	SHORT NUT SER32	M40X1.5	14
F15500-40SER	SHORT NUT SER40	M50X1.5	20

Accessories



For Further Details Please Refer Accessories Catalog.

Pre balanced G6.3@15000 RPM
 Fine balancing G2.5@25000 RPM on request



SK (DIN 69871)

SK – Form ADB – G6.3

SK 40 – Standard GPL

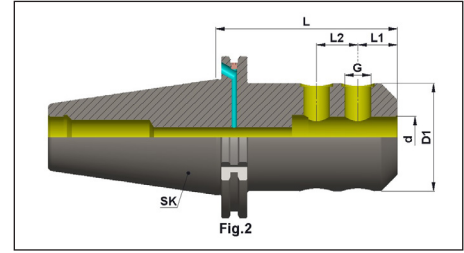
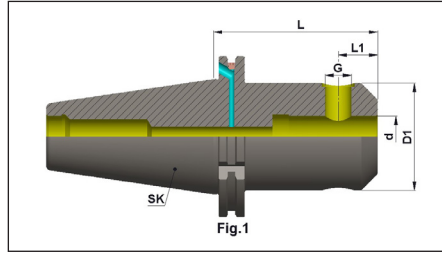

Part No.	Product name	Taper	Form	d.	L	D1	G	L1	L2	FIG	Kgs	Group
F1S409A-EMH06050	SK40 ADB EM 06 050	40	AD/B	6	50	25	M6	18	-	1	0.9	B
F1S409A-EMH08050	SK40 ADB EM 08 050	40	AD/B	8	50	28	M8	18	-	1	0.9	B
F1S409A-EMH12050	SK40 ADB EM 12 050	40	AD/B	12	50	42	M12	22.5	-	1	1.2	B
F1S409A-EMH14050	SK40 ADB EM 14 050	40	AD/B	14	50	44	M12	22.5	-	1	1.2	B
F1S409A-EMH16063	SK40 ADB EM 16 063	40	AD/B	16	63	48	M14	24	-	1	1.2	B
F1S409A-EMH18063	SK40 ADB EM 18 063	40	AD/B	18	63	50	M14	24	-	1	1.3	B
F1S409A-EMH20063	SK40 ADB EM 20 063	40	AD/B	20	63	52	M16	25	-	1	1.4	B
F1S409A-EMH25100	SK40 ADB EM 25 100	40	AD/B	25	100	65	M18X2	24	25	2	1.6	B
F1S409A-EMH32100	SK40 ADB EM 32 100	40	AD/B	32	100	72	M20X2	24	28	2	3.3	B
F1S409A-EMH40120	SK40 ADB EM 40 120	40	AD/B	40	120	80	M20X2	30	32	2	4.7	B
F1S409A-EMH10050	SK40 ADB EM 10 050	40	AD/B	10	50	35	M10	20	-	1	0.9	B

SK 40 - GPL = 160 mm

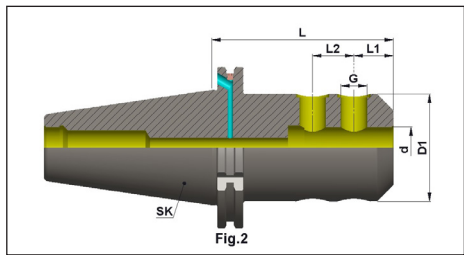
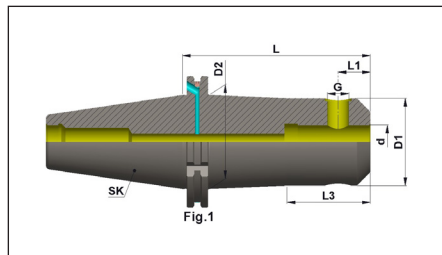

Part No.	Product name	Taper	Form	d.	L	D1	D2	G	L1	L2	L3	FIG	Kgs	Group
F1S409A-EMH06160	SK40 ADB EM 06 160	40	AD/B	6	160	25	35	M6	18	-	30	1	1.2	B
F1S409A-EMH08160	SK40 ADB EM 08 160	40	AD/B	8	160	28	38	M8	18	-	32	1	1.2	B
F1S409A-EMH10160	SK40 ADB EM 10 160	40	AD/B	10	160	35	40	M10	20	-	35	1	1.5	B
F1S409A-EMH12160	SK40 ADB EM 12 160	40	AD/B	12	160	42	-	M12	22.5	-	-	1	1.7	B
F1S409A-EMH16160	SK40 ADB EM 16 160	40	AD/B	16	160	48	-	M14	24	-	-	1	2	B
F1S409A-EMH20160	SK40 ADB EM 20 160	40	AD/B	20	160	52	-	M16	25	-	-	1	2.7	B
F1S409A-EMH25160	SK40 ADB EM 25 160	40	AD/B	25	160	65	-	M18X2	24	25	-	2	2.6	B

Pre balanced G6.3@15000 RPM
 Fine balancing G2.5@25000 RPM on request



SK (DIN 69871)

SK 50 – Standard GPL

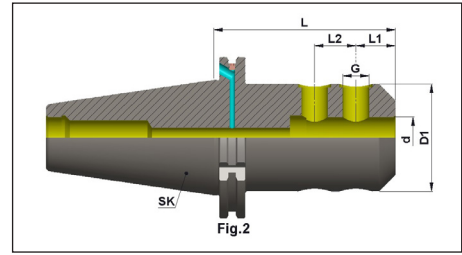
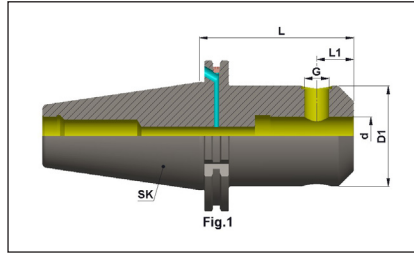

Part No.	Product name	Taper	Form	d.	L	D1	G	L1	L2	FIG	Kgs	Group
F1S509A-EMH06063	SK50 ADB EM 06 063	50	AD/B	6	63	25	M6	18	-	1	2.7	B
F1S509A-EMH08063	SK50 ADB EM 08 063	50	AD/B	8	63	28	M8	18	-	1	2.7	B
F1S509A-EMH10063	SK50 ADB EM 10 063	50	AD/B	10	63	35	M10	20	-	1	2.8	B
F1S509A-EMH12063	SK50 ADB EM 12 063	50	AD/B	12	63	42	M12	22.5	-	1	2.9	B
F1S509A-EMH14063	SK50 ADB EM 14 063	50	AD/B	14	63	44	M12	22.5	-	1	3	B
F1S509A-EMH16063	SK50 ADB EM 16 063	50	AD/B	16	63	48	M14	24	-	1	3	B
F1S509A-EMH18063	SK50 ADB EM 18 063	50	AD/B	18	63	50	M14	24	-	1	3.1	B
F1S509A-EMH20063	SK50 ADB EM 20 063	50	AD/B	20	63	52	M16	25	-	1	3.2	B
F1S509A-EMH25080	SK50 ADB EM 25 080	50	AD/B	25	80	65	M18X2	24	25	2	3.3	B
F1S509A-EMH32100	SK50 ADB EM 32 100	50	AD/B	32	100	72	M20X2	24	28	2	4.3	B
F1S509A-EMH40100	SK50 ADB EM 40 100	50	AD/B	40	100	90	M20X2	30	32	2	5.5	B

SK 50 - GPL = 160mm

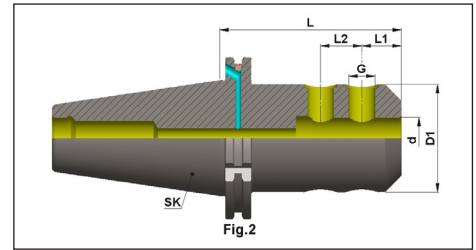
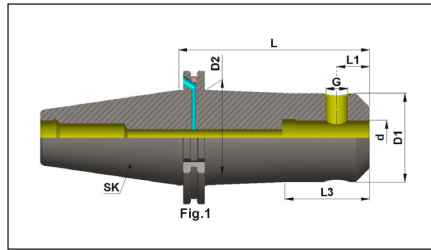

Part No.	Product name	Taper	Form	d.	L	D1	D2	G	L1	L2	L3	FIG	Kgs	Group
F1S509A-EMH06160	SK50 ADB EM 06 160	50	AD/B	6	160	25	35	M6	18	-	30	1	3	B
F1S509A-EMH08160	SK50 ADB EM 08 160	50	AD/B	8	160	28	38	M8	18	-	32	1	3	B
F1S509A-EMH10160	SK50 ADB EM 10 160	50	AD/B	10	160	35	42	M10	20	-	35	1	3.2	B
F1S509A-EMH12160	SK50 ADB EM 12 160	50	AD/B	12	160	42	48	M12	22.5	-	35	1	3.5	B
F1S509A-EMH14160	SK50 ADB EM 14 160	50	AD/B	14	160	44	50	M12	22.5	-	35	1	3.6	B
F1S509A-EMH16160	SK50 ADB EM 16 160	50	AD/B	16	160	48	54	M14	24	-	40	1	3.8	B
F1S509A-EMH18160	SK50 ADB EM 18 160	50	AD/B	18	160	50	56	M14	24	-	40	1	4	B
F1S509A-EMH20160	SK50 ADB EM 20 160	50	AD/B	20	160	52	59	M16	25	-	45	1	4.5	B
F1S509A-EMH25160	SK50 ADB EM 25 160	50	AD/B	25	160	65	70	M18X2	24	25	62	2	4.4	B
F1S509A-EMH32160	SK50 ADB EM 32 160	50	AD/B	32	160	72	-	M20X2	24	28	-	2	5.2	B

Pre balanced G6.3@15000 RPM
 Fine balancing G2.5@25000 RPM on request



SK (DIN 69871)

Spares

Grub Screw

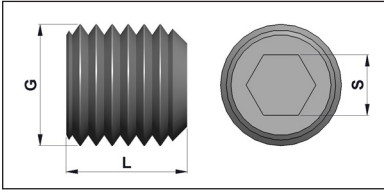

Part No.	G	L	S
F1GSWD-10M06	M6	10	3
F1GSWD-10M08	M8	10	4
F1GSWD-12M10	M10	12	5
F1GSWD-16M12	M12	16	6
F1GSWD-16M14	M14	16	6
F1GSWD-16M16	M16	16	8
F1GSWD-20M18	M18	20	10
F1GSWD-20M20	M20	20	10
F1GSWD-25M24	M24	25	12

Accessories



For Further Details Please Refer Accessories Catalog.

Pre balanced G6.3@15000 RPM
Fine balancing G2.5@25000 RPM on request



SK (DIN 69871)

SK 40 - Form AD

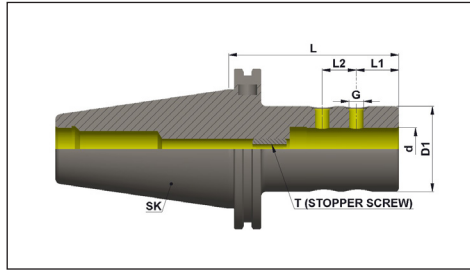

Part No.	Product name	Taper	Form	d.	L	G	D1	L1	L2	T	Kgs	Group
F1S401A-SLA20090	SK40 AD SLA 20 090	40	AD	20	90	M10	50	25	20	M12	1.7	B
F1S401A-SLA25090	SK40 AD SLA 25 090	40	AD	25	90	M10	50	25	20	M12	1.6	B
F1S401A-SLA32090	SK40 AD SLA 32 090	40	AD	32	90	M10	60	30	20	M12	1.8	B
F1S401A-SLA40090	SK40 AD SLA 40 090	40	AD	40	90	M12	63	30	20	M12	1.6	B

SK 50 - Form AD

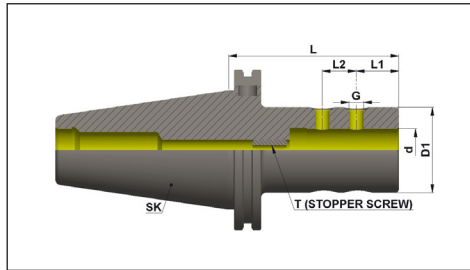

Part No.	Product name	Taper	Form	d.	L	G	D1	L1	L2	T	Kgs	Group
F1S501A-SLA20105	SK50 AD SLA 20 105	50	AD	20	105	M10	50	25	20	M12	3.7	B
F1S501A-SLA25105	SK50 AD SLA 25 105	50	AD	25	105	M10	50	25	20	M12	3.6	B
F1S501A-SLA32105	SK50 AD SLA 32 105	50	AD	32	105	M10	60	30	20	M12	4	B
F1S501A-SLA40105	SK50 AD SLA 40 105	50	AD	40	105	M12	70	30	20	M12	4.4	B

Pre balanced G6.3@15000 RPM
 Fine balancing G2.5@25000 RPM on request



SK (DIN 69871)

Spares

Grub Screw

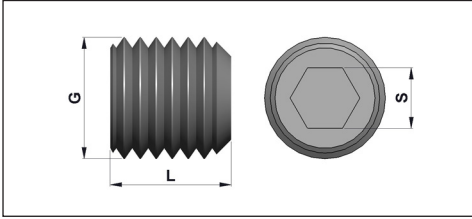

Part No.	G	L	S
F1GSWD-10M06	M6	10	3
F1GSWD-10M08	M8	10	4
F1GSWD-12M10	M10	12	5
F1GSWD-16M12	M12	16	6
F1GSWD-16M14	M14	16	6
F1GSWD-16M16	M16	16	8
F1GSWD-20M18	M18	20	10
F1GSWD-20M20	M20	20	10
F1GSWD-25M24	M24	25	12

Accessories



For Further Details Please Refer Accessories Catalog.

Pre balanced G6.3@15000 RPM
Fine balancing G2.5@25000 RPM on request



SK (DIN 69871)

SK – Form ADB – G6.3

SK 40 – Standard GPL

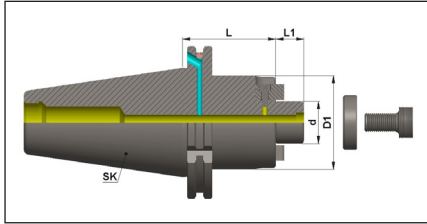

Part No.	Product name	Taper	Form	d.	L	L1	D1	Cutter Dia	Kgs	Group
F1S409A-SMS16060	SK40 ADB SMS 16 060	40	AD/B	16	60	17	34	40	1.1	B
F1S409A-SMS22060	SK40 ADB SMS 22 060	40	AD/B	22	60	19	48	50 & 63	1.4	B
F1S409A-SMS27045	SK40 ADB SMS 27 045	40	AD/B	27	45	21	60	80	1.4	B
F1S409A-SMS32060	SK40 ADB SMS 32 060	40	AD/B	32	60	24	70	100	2	B
F1S409A-SMS40060	SK40 ADB SMS 40 060	40	AD/B	40	60	27	80	125	2.4	B

SK 50 – Standard GPL

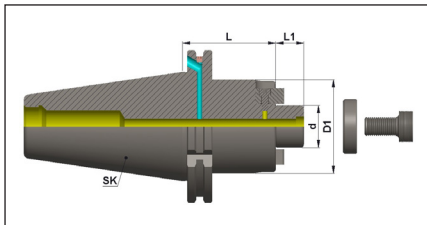

Part No.	Product name	Taper	Form	d.	L	L1	D1	Cutter Dia	Kgs	Group
F1S509A-SMS22060	SK50 ADB SMS 22 060	50	AD/B	22	60	19	48	50 & 63	3.4	B
F1S509A-SMS27060	SK50 ADB SMS 27 060	50	AD/B	27	60	21	60	80	3.6	B
F1S509A-SMS32060	SK50 ADB SMS 32 060	50	AD/B	32	60	24	70	100	4	B
F1S509A-SMS40060	SK50 ADB SMS 40 060	50	AD/B	40	60	27	80	125	5	B

Pre balanced G6.3@15000 RPM
 Fine balancing G2.5@25000 RPM on request



Spares

Cutter Clamping Screw

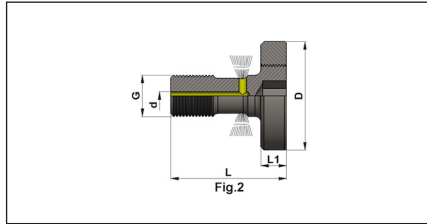
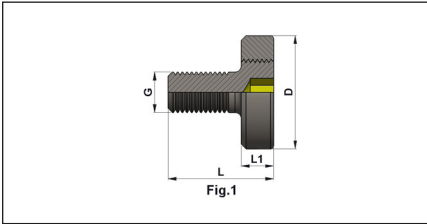

Part No.	D	L	L1	G	d.	Allen Key	FIG	Remarks
F1CCSN-22M10	28	26	8	M10	-	6mm	1	NORMAL
F1CCSN-16M08	20	23	7	M8	-	5mm	1	NORMAL
F1CCSN-27M12	35	31	9	M12	-	8mm	1	NORMAL
F1CCSN-32M16	42	36	10	M16	-	10mm	1	NORMAL
F1CCSN-40M20	52	41	11	M20	-	12mm	1	NORMAL
F1CCSN-60M30	75	60	15	M30	-	17mm	1	NORMAL
F1CCSN-50M24	75	49	13	M24	-	14mm	1	NORMAL
F1CCST-22M10	28	33	8	M10	3.2	6mm	2	THRU COOLANT
F1CCST-16M08	20	32	7	M8	2.5	5mm	2	THRU COOLANT
F1CCST-27M12	35	44	9	M12	3.2	8mm	2	THRU COOLANT
F1CCST-32M16	42	45	10	M16	3.2	10mm	2	THRU COOLANT
F1CCST-40M20	52	51	11	M20	3.2	12mm	2	THRU COOLANT

Driving Key

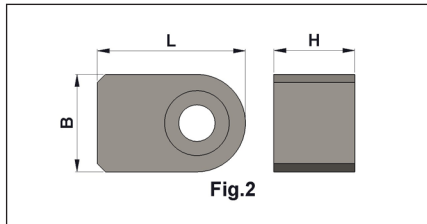
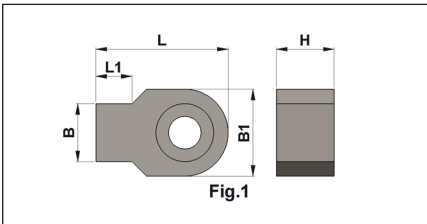

Part No.	Product name	B	b1	L	L1	H	Allen Screw	FIG
F1DRKY-08S16	DRIVING KEY 08 16	8	12	17.5	5	8	M4	1
F1DRKY-10S22	DRIVING KEY 10 22	10	12	18.3	7.5	10	M4	1
F1DRKY-12S27	DRIVING KEY 12 27	12	-	18.3	-	10	M4	2
F1DRKY-14S32	DRIVING KEY 14 32	14	-	24	-	13	M5	2
F1DRKY-16S40	DRIVING KEY 16 40	16	-	24	-	16	M6	2

Accessories



For Further Details Please Refer Accessories Catalog.

Pre balanced G6.3@15000 RPM
Fine balancing G2.5@25000 RPM on request



SK (DIN 69871)

SK – Form AD – G6.3

SK 40 – Standard GPL

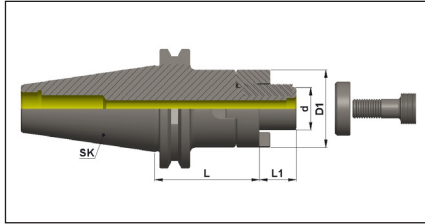
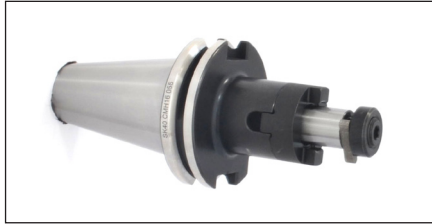

Part No.	Product name	Taper	Form	d.	L	L1	D1	Kgs	Group
F1S401A-CMH32060	SK40 AD CMH 32 060	40	AD	32	60	24	58	2.2	B
F1S401A-CMH16055	SK40 AD CMH 16 055	40	AD	16	55	17	32	1.1	B
F1S401A-CMH22055	SK40 AD CMH 22 055	40	AD	22	55	19	40	1.4	B
F1S401A-CMH27055	SK40 AD CMH 27 055	40	AD	27	55	21	48	1.6	B

SK 50 – Standard GPL

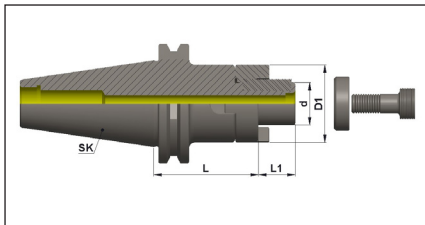

Part No.	Product name	Taper	Form	d.	L	L1	D1	Kgs	Group
F1S501A-CMH22055	SK50 AD CMH 22 055	50	AD	22	55	17	40	3.4	B
F1S501A-CMH27055	SK50 AD CMH 27 055	50	AD	27	55	19	48	3.6	B
F1S501A-CMH32060	SK50 AD CMH 32 060	50	AD	32	60	21	58	4	B
F1S501A-CMH40060	SK50 AD CMH 40 060	50	AD	40	60	24	70	5	B

Spares

Drive Ring

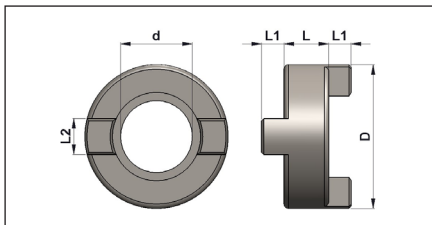

Part No.	d.	D	L	L1	L2
F1DRRG-CMH16	16	32	10	5	8
F1DRRG-CMH22	22	40	12	5.6	10
F1DRRG-CMH27	27	48	12	6.3	12
F1DRRG-CMH32	32	58	14	7	14
F1DRRG-CMH40	40	70	14	8	16

Pre balanced G6.3@15000 RPM
 Fine balancing G2.5@25000 RPM on request



SK (DIN 69871)

Parallel Key

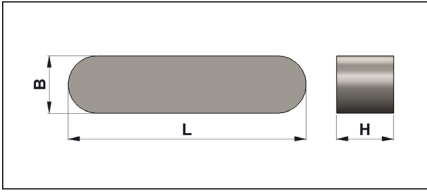

Part No.	Product name	d.	B	H	L
F1PLKY-04020	PARALLEL KEY 4x20	16	4	4	20
F1PLKY-06025	PARALLEL KEY 6x25	22	6	6	25
F1PLKY-07025	PARALLEL KEY 7x25	27	7	7	25
F1PLKY-08028	PARALLEL KEY 8x28	32	8	7	28
F1PLKY-10032	PARALLEL KEY 10x32	40	10	8	32

Cutter Clamping Screw

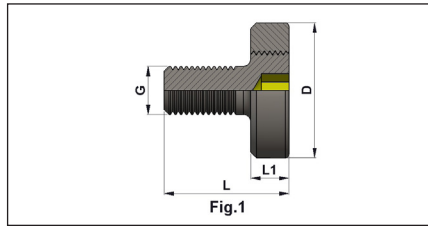
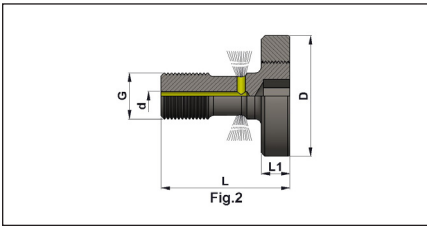

Part No.	D	L	L1	G	d.	Allen Key	FIG	Remarks
F1CCSN-22M10	28	26	8	M10	-	6mm	1	NORMAL
F1CCSN-16M08	20	23	7	M8	-	5mm	1	NORMAL
F1CCSN-27M12	35	31	9	M12	-	8mm	1	NORMAL
F1CCSN-32M16	42	36	10	M16	-	10mm	1	NORMAL
F1CCSN-40M20	52	41	11	M20	-	12mm	1	NORMAL
F1CCSN-60M30	75	60	15	M30	-	17mm	1	NORMAL
F1CCSN-50M24	75	49	13	M24	-	14mm	1	NORMAL
F1CCST-22M10	28	33	8	M10	3.2	6mm	2	THRU COOLANT
F1CCST-16M08	20	32	7	M8	2.5	5mm	2	THRU COOLANT
F1CCST-27M12	35	44	9	M12	3.2	8mm	2	THRU COOLANT
F1CCST-32M16	42	45	10	M16	3.2	10mm	2	THRU COOLANT
F1CCST-40M20	52	51	11	M20	3.2	12mm	2	THRU COOLANT

Accessories



For Further Details Please Refer Accessories Catalog.

Pre balanced G6.3@15000 RPM
Fine balancing G2.5@25000 RPM on request



SK (DIN 69871)

SK – Form AD

SK 40 – Standard GPL

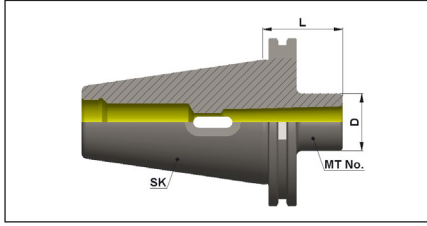

Part No.	Product name	Taper	Form	MT No.	L	D1	Kgs	Group
F1S401A-MTA01045	SK40 AD MTA 01 045	40	AD	1	45	25	0.8	B
F1S401A-MTA02060	SK40 AD MTA 02 060	40	AD	2	60	32	0.9	B
F1S401A-MTA03075	SK40 AD MTA 03 075	40	AD	3	75	40	1.1	B
F1S401A-MTA04095	SK40 AD MTA 04 095	40	AD	4	95	48	1.4	B

SK 50 – Standard GPL

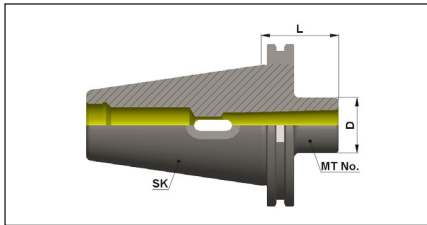

Part No.	Product name	Taper	Form	MT No.	L	D1	Kgs	Group
F1S501A-MTA01045	SK50 AD MTA 01 045	50	AD	1	45	25	2.5	B
F1S501A-MTA02045	SK50 AD MTA 02 045	50	AD	2	45	32	2.5	B
F1S501A-MTA03045	SK50 AD MTA 03 045	50	AD	3	45	40	2.5	B
F1S501A-MTA04075	SK50 AD MTA 04 075	50	AD	4	75	48	2.8	B
F1S501A-MTA05105	SK50 AD MTA 05 105	50	AD	5	105	70	3.7	B

SK – Form A

SK 40 – Extended Length

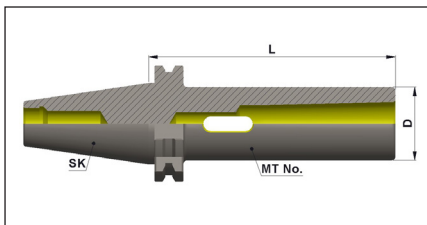

Part No.	Product name	Taper	Form	MT No.	L	D1	Kgs	Group
F1S405A-MTA01120	SK40 A MTA 01 120	40	A	1	120	25	1.3	B
F1S405A-MTA02120	SK40 A MTA 02 120	40	A	2	120	32	1.3	B
F1S405A-MTA03135	SK40 A MTA 03 135	40	A	3	135	40	1.6	B

Pre balanced G6.3@15000 RPM
 Fine balancing G2.5@25000 RPM on request



SK (DIN 69871)

SK 50 - Extended Length

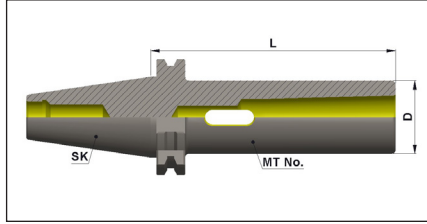

Part No.	Product name	Taper	Form	MT No.	L	D1	Kgs	Group
F1S505A-MTA01120	SK50 A MTA 01 120	50	A	1	120	25	2.9	B
F1S505A-MTA02135	SK50 A MTA 02 135	50	A	2	135	32	3.1	B
F1S505A-MTA03150	SK50 A MTA 03 150	50	A	3	150	40	3.5	B
F1S505A-MTA04180	SK50 A MTA 04 180	50	A	4	180	48	4.3	B

Accessories



For Further Details Please Refer Accessories Catalog.

Pre balanced G6.3@15000 RPM
Fine balancing G2.5@25000 RPM on request



SK (DIN 69871)

SK – Form ADB – G6.3

SK 40 – Standard GPL

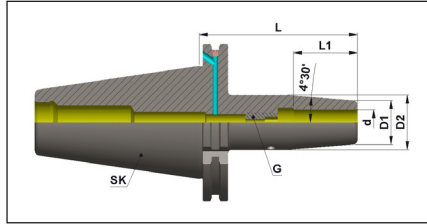

Part No.	Product name	Taper	Form	d.	L	D1	D2	L1	G	Kgs	Group
F1S409A-SFC08080	SK40 ADB SFC 08 080	40	AD/B	8	80	21	27	36	M6	1	B
F1S409A-SFC06080	SK40 ADB SFC 06 080	40	AD/B	6	80	21	27	36	M5	1	B
F1S409A-SFC10080	SK40 ADB SFC 10 080	40	AD/B	10	80	24	32	42	M8X1	1.1	B
F1S409A-SFC12080	SK40 ADB SFC 12 080	40	AD/B	12	80	24	32	47	M10X1	1	B
F1S409A-SFC14080	SK40 ADB SFC 14 080	40	AD/B	14	80	27	34	47	M10X1	1.1	B
F1S409A-SFC16080	SK40 ADB SFC 16 080	40	AD/B	16	80	27	34	50	M12x1	1	B
F1S409A-SFC18080	SK40 ADB SFC 18 080	40	AD/B	18	80	33	42	50	M12X1	1.2	B
F1S409A-SFC20080	SK40 ADB SFC 20 080	40	AD/B	20	80	33	42	52	M16X1	1.1	B
F1S409A-SFC25100	SK40 ADB SFC 25 100	40	AD/B	25	100	44	53	58	M16X1	1.8	B

Spares

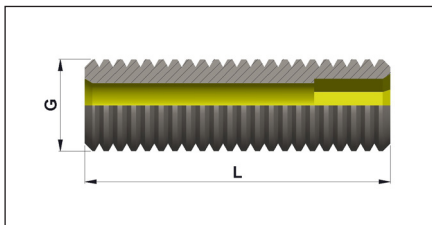

Part No.	G	L
F1SCWM-20M06	M6	20
F1SCWM-20M08	M8	20
F1SCWM-20M10	M10	20
F1SCWM-20M12	M12	20
F1SCWM-20M16	M16	20
F1SCWM-20M05	M5	20

Accessories



For Further Details Please Refer Accessories Catalog.

Pre balanced G6.3@15000 RPM
Fine balancing G2.5@25000 RPM on request



SK (DIN 69871)

SK – Form A

SK 40 – Standard GPL

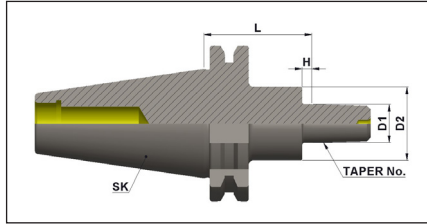

Part No.	Product name	Taper	Form	Taper No.	L	Clamping range	D1	D2	H	Kgs	Group
F1S405X-JTA06045	SK40 A JTA 06 045	40	A	JTA6	45	0.8 - 13	30	17.17	4	1.1	A
F1S405X-DCB16045	SK40 A B16 045	40	A	B16	45	0.8 - 13	30	15.73	4	1.1	A

SK 50 – Standard GPL

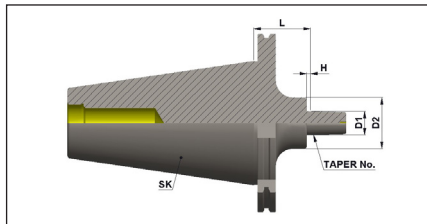
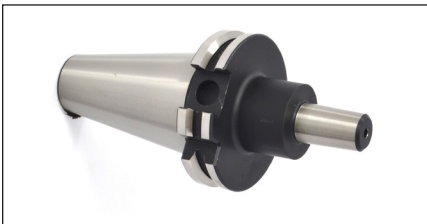

Part No.	Product name	Taper	Form	Taper No.	L	Clamping range	D1	D2	H	Kgs	Group
F1S505X-JTA06045	SK50 A JTA 06 045	50	A	JTA6	45	0.8 - 13	30	17.17	3.2	3.7	A
F1S505X-DCB16045	SK50 A B16 045	50	A	B16	45	0.8 - 13	30	15.73	4	3.7	A

Accessories



For Further Details Please Refer Accessories Catalog.

Pre balanced G6.3@15000 RPM
 Fine balancing G2.5@25000 RPM on request



SK (DIN 69871)

SK – Form A

SK 40 – Standard GPL

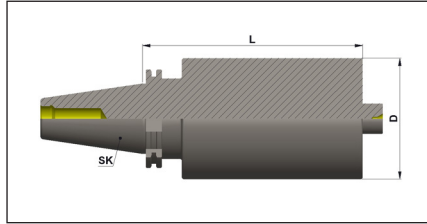

Part No.	Product name	Taper	Form	D	L	Kgs	Group
F1S405X-BLA063250	SK40 A BLANK 063 250	40	A	63	250	6.3	B
F1S405X-BLA080250	SK40 A BLANK 080 250	40	A	80	200	9.5	B

SK 50 – Standard GPL

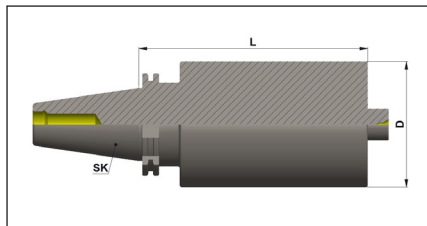

Part No.	Product name	Taper	Form	D	L	Kgs	Group
F1S505X-BLA080250	SK50 A BLANK 080 250	50	A	80	250	11.6	B
F1S505X-BLA100300	SK50 A BLANK 100 300	50	A	100	300	19.6	B

Accessories



For Further Details Please Refer Accessories Catalog.

Pre balanced G6.3@15000 RPM
Fine balancing G2.5@25000 RPM on request





Falcon®

Falcon Toolings

SF. No. 205 / 1 & 2, Kalapatti, Coimbatore - 641 048, India

Ph : +91 (422) 266 6156 , +91 (422) 266 6322

Email : sales@falcontoolings.com

Web: www.falcontoolings.com